

Remarks: See §9.3.3, page 363 till 369

Answers:

There're 6 zero-force members: 1, 3, 6, 7, 8 en 9
See figure

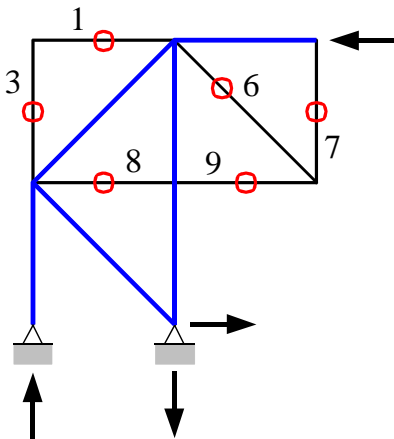

Remarks:

The fact that members 1 and 3 are zero-force members follows immediately from an unloaded corner with only two members. Because member 7 is a zero-force member, 6, 9 and 8 are also zero-force members.

The blue members in the figure aren't zero-force members but guide the load to the ground